

# Fact Sheet for Spring semester, 2022

**\*The information on this Factsheet might be changed due to the effect of COVID-19.**

## General and Contact Information

<b>Country</b>	Japan
<b>City</b>	Hachioji, Tokyo
<b>Year of Founding</b>	1971
<b>Type of Institution</b>	Private
<b>Majors (Undergraduate)</b>	Economics, Business Administration, Law, Letters, Education, Science and Engineering, Nursing, International Liberal Arts
<b>Office Address</b>	Soka University, International Affairs Office 1-236, Tangi-machi, Hachioji-Shi Tokyo, Japan 192-8577
<b>Office Telephone / Fax</b>	+81-42-691-8200 / +81-42-691-2039
<b>English Homepage</b>	<a href="http://www.soka.ac.jp/en/">http://www.soka.ac.jp/en/</a>

## Nomination Deadlines for Inbound Exchange

In order to be nominated as an exchange student, home institutions email to Soka University including (1) nominee's Name, (2) Gender, (3) Date of birth, (4) Major (5) Exchange period (Spring / Spring and Fall), (6) Email address, (7) Special needs \*If students need special needs, please describe it.

<b>2022 Spring semester (April – July 2022)</b>	Friday, October 15, 2021
<b>2022 Fall semester (Sep, 2022 - Jan, 2023)</b>	Mid-March, 2022

## Application Deadlines for Inbound Exchange

<b>2022 Spring semester (April – July 2022)</b>	Saturday, October 30, 2021
<b>2022 Fall semester (Sep, 2022 – Jan, 2023)</b>	Late-March, 2022

## Academic Calendar *\*Tentative*

\*Newest academic calendar will be informed 1 month before the arrival date.

### Spring Semester Dates (April - July 2022)

<b>Arrival date/Airport Pickup</b>	
<b>Dormitory move-in</b>	Late-March, 2022
<b>Orientation starts</b>	
<b>Opening ceremony</b>	Early-April, 2022
<b>Classes start</b>	
<b>Mid-term exam period</b>	Mid-May – Mid-June, 2022
<b>Final-exam period</b>	Mid-July to Late-July, 2022
<b>Completion ceremony</b>	Late-July, 2022
<b>Summer Break</b>	Late-July – Mid-September, 2022
<b>Move-out date</b>	Early-August, 2022

### Fall Semester Dates (Sep 2022 - Jan 2023)

<b>Arrival date/Airport Pickup</b>	
<b>Dormitory move-in</b>	Early-Sep, 2022
<b>Orientation starts</b>	
<b>Classes start</b>	Mid-Sep, 2022
<b>Mid-term exam period</b>	Late-Oct - Mid-Nov, 2022
<b>Winter break</b>	Late-Dec, 2022 – Early-Jan, 2023
<b>Final-exam period</b>	Late-Jan, 2023
<b>Completion ceremony</b>	
<b>Spring Break</b>	Late-Jan – Late-March, 2023
<b>Move-out date</b>	Early-Feb, 2023

## Study Area & Course registration

\*Each class is 90 min

\* You need to take at least 7 classes per week.

\*All students are eligible to enroll in the Japanese-language courses below and Physical Education courses.

<p><b>Undergraduate class</b></p>	<p>Students who have N2 level on JLPT or above are eligible to enroll in some elective undergraduate level classes taught in Japanese. Students who have TOEFL iBT 71 or above are eligible to enroll in some elective undergraduate level classes taught in English.</p> <p><i>*Refer to the class list to check which class is available.</i></p> <p>Each undergraduate class is equivalent to 2 to 4 credits depending on the course.</p>
<p><b>Japanese Language course</b></p>	<p>Japanese Language courses are categorized into seven proficiency classes: ES to E5. Students can take Japanese language classes up to 8 credits per semester.</p> <p>Students going-on to their first semester: Level of class will be chosen, based on the results of your placement test.</p> <p>Students going-on to their second semester and on: You will be placed in the subsequent class this semester. For example, students who were E0 will proceed to E1. Students who were in E5, will remain in E5.</p> <p>Class hours per week: At least 10 hours (600 minutes) of class (at least 7 classes) per week.</p> <p>Each Japanese Language course is equivalent to 1 to 2 credits depending on the course.</p>

### Language Levels

ES	Minimal but necessary Japanese language study level to live in Japan.
E0	Basic level
E1	Basic level
E2	Intermediate level
E3	Intermediate level
E4	Pre-Advanced level
E5	Advanced level

## Course Information

**Undergraduate classes:**

<https://sokauniversity.box.com/v/courselists2021v2>

**Japanese Language Courses:**

<https://www.soka.ac.jp/en/academics/japan-studies-center/non-degree/japanese-courses>

**Syllabus:**

<http://plas.soka.ac.jp/csp/plas/syllabus11.csp>

## Admission Procedure flow \*tentative (AFTER applying for the student exchange program)

\*Students will be informed the newest admission procedure flow and documents by the staff of International Affairs Office, Soka University. All dates are subject to change.

	Submission Deadline	
	Spring	Fall
Students submit the "Arrival Information & Airport Pick-up Request Form"	Late-Feb, 2022	Late-July, 2022
Soka University will ship-out the <i>Acceptance letter</i> and <i>Certificate of Eligibility</i> which are necessary for issuing his/her student visa.	Around two months before the arrival	
Students must apply and obtain their student visa at the Japanese Embassy in their home country BEFORE entering into Japan.	AFTER receiving Acceptance letter and CoE from Soka University by mail.	
Airport pick-up day	Late-March, 2022	Early-Sep, 2022
Agreement on Handling Personal Info at Soka Univ.	Orientation week AFTER arriving on campus *all documents are distributed during the orientation	
Dormitory Terms of Agreement		
Copy of passport and residence card		

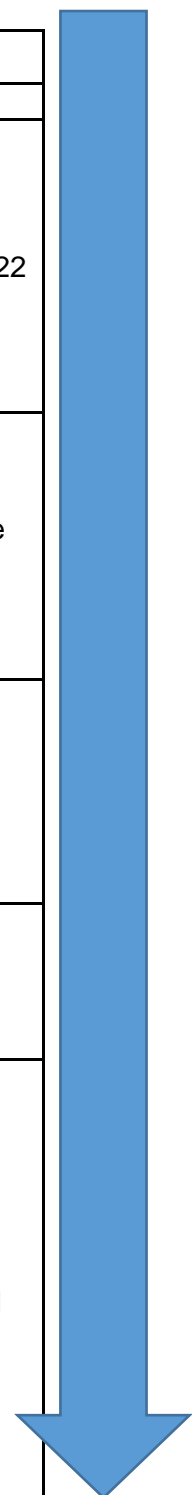

## Campus Guide

### **Soka University campus map (English):**

- <https://www.soka.ac.jp/en/about/campusmap/>
- [https://www.soka.ac.jp/files/en/20170705\\_123811.pdf](https://www.soka.ac.jp/files/en/20170705_123811.pdf)

### **Soka University campus map (Japanese):**

- <https://www.soka.ac.jp/about/campusmap/>

### **Cafeterias on Campus**

- New Prince Hall
- New Loire
- Central Tower 13<sup>th</sup> floor

### **Students also have access to food at:**

- Gran café 4<sup>th</sup> floor of Global Square
- Convenience Store inside Global Square as well as Student Hall \*Some Halal foods available

### **Other services:**

- ATMs are available on the 1<sup>st</sup> floor of Student Hall.
- Health Center is located at B1 floor on the East wing of the Global Square for all students.
- Gym facilities are available for students on the 3<sup>rd</sup> floor of the Gymnasium.

You can check each store's business hours through this website:

<https://sogakuservice.co.jp/eigyotime/>

All meals are approximately 250-500JPY

## International Dormitories

Soka University provides dormitories (fee exempt) for exchange students.

### **Dormitory Rules**

Each dormitory has its own rules on curfew, shower time, cleaning time, etc.

### **Bedding and Furniture**

Each dormitory rooms will come furnished with bedding.

### **Eating at the dormitories (male dormitories only)**

Only male dormitories (Hoyu and Takiyama International dormitories) include cafeterias inside. Exchange students living in these dormitories preferring to eat in the cafeterias may purchase meal tickets at the Certificate Issuing Machine at the university after their arrival, on the monthly cost of 22,500 JPY\* for breakfast and dinner (from Mondays to Saturdays). Students in dormitories without cafeterias have access to cafeterias on campus and kitchen space in the living rooms of each dormitory.

## 【Dormitories for Female Exchange Students】

### ● Cosmos Dormitory

◆ **Western style room**

◆ **Single room**

◆ **Bedroom furniture:** Bed, closet, chest, desk, chair, bookshelf

◆ **Joint facilities:** Bath room, toilet, kitchen (IH stove, microwave oven, fridge, rice cooker), meeting room, lounge, Japanese style room, coin laundry machine and dryer, air conditioner

◆ **Address:** 1-582-1 Takiyama-cho, Hachioji-shi, Tokyo  
(outside campus - 20 minutes on foot)

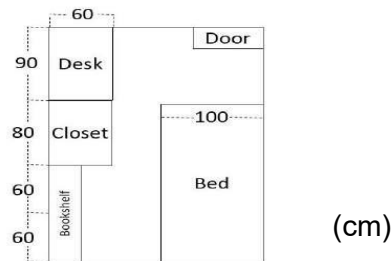

### ● Yuko Dormitory

◆ **Western style room**

◆ **Single room**

◆ **Bedroom furniture:** Bed, closet, chest, desk, chair, bookshelf

◆ **Joint facilities:** Bath room, toilet, kitchen (IH stove, microwave oven, fridge, rice cooker), meeting room, lounge, Japanese style room, coin laundry machine and dryer, air conditioner

◆ **Address:** 1-481, Takiyama-cho, Hachioji-shi, Tokyo  
(outside campus - 20 minutes on foot)

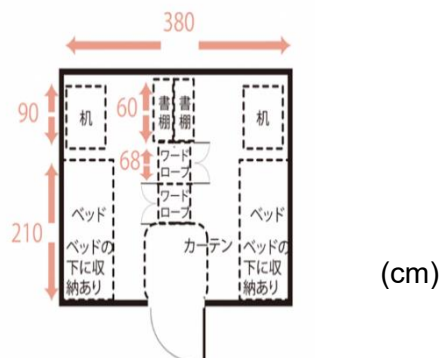

## 【Dormitories for Male Exchange Students】

### ● Hoyu Dormitory Intl. Block

◆ **Western style room**      ◆ **Single room**

◆ **Bedroom furniture:** Bed, closet, chest, desk, chair, bookshelf, air conditioner

◆ **Joint facilities:** Bathroom (shower and tub), toilet, cafeteria, kitchen, (induction stove, microwave oven, fridge), meeting room, lounge, Japanese style room, coin laundry machine and dryer, air conditioner

◆ **Cafeteria**

※There is no meal service in the cafeteria in March and in August

◆ **Address** 1-483 Takiyama-cho, Hachioji-shi, Tokyo (outside campus - 20 minutes on foot)

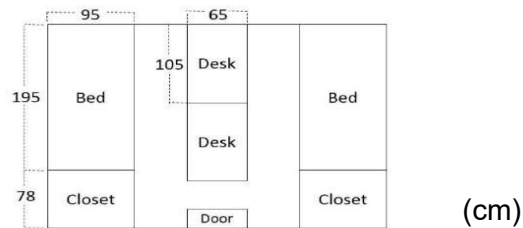

### ● Takiyama Intl. Dormitory

◆ **Western style room**      ◆ **Single room**

◆ **Bedroom furniture:** Bed, closet, chest, desk, chair, bookshelf, air conditioner

◆ **Joint facilities:** Bathroom, toilet, dining room, kitchen (microwave, fridge), multipurpose room, meeting room, lounge, coin laundry machine and dryer, air conditioner

◆ **Cafeteria**

※There is no meal service in the cafeteria in March and in August

◆ **Address:** 1-236 Tangi-machi, Hachioji-shi, Tokyo (Located on Campus)

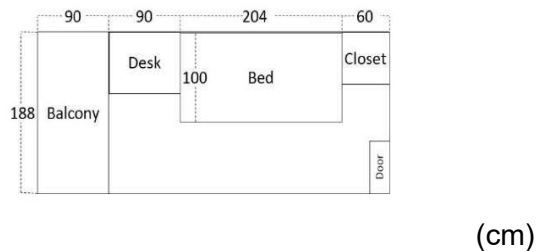



## SOKA UNIVERSITY

I-236 Tangi-machi, Hachioji City, Tokyo, 192-8577 Japan

Tel : +81-42-691-2215 Fax1 : +81-42-691-9300

- About 25 minutes ( 6 kilometers ) by bus from the north exit of Hachioji Station, which is roughly 50 minutes from Shinjuku Station by JR Chuo Line or Keio Line.
- About 2 kilometers northwest of the Hachioji Interchange on the Chuo Expressway.

Contact:

[outbound@soka.ac.jp](mailto:outbound@soka.ac.jp)

[intloff@soka.ac.jp](mailto:intloff@soka.ac.jp)